

Note: S.L. - Shadow Lake

# 83 Base Line Road, geographic Township Somerville



**Legend**

-  Property ROLL#
-  Lots and Concessions
-  Road Centreline
-  Upper Municipalities
-  Light Gray Canvas Base

**Notes**

1651 310 050 37400

This map is a user generated static output from an Internet mapping site and is for reference only. Data layers that appear on this map may or may not be accurate, current, or otherwise reliable.  
**THIS MAP IS NOT TO BE USED FOR COMMERCIAL OR LEGAL PURPOSES**



INDUSTRIAL ZONE  
INDUSTRIAL ZONE  
INDUSTRIAL ZONE  
INDUSTRIAL ZONE

Section 18.10  
Section 18.25

A  
CODE  
BYLAWS

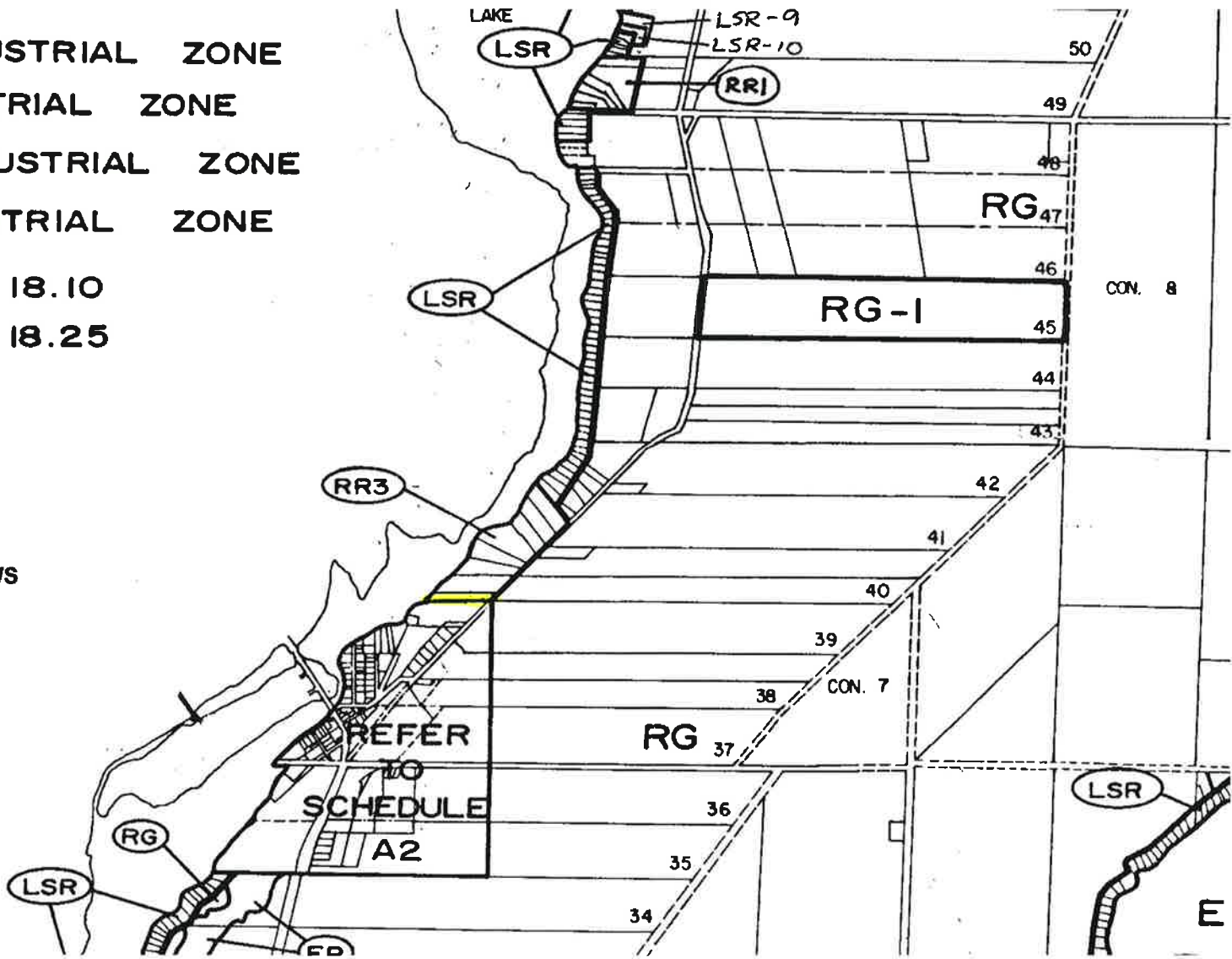

**SECTION 4**

**RURAL RESIDENTIAL TYPE THREE (RR3) ZONE**

**4.1 RR3 USES PERMITTED**

No persons shall hereafter change the use of any building, structure or land or erect or use any building, or structure in a Rural Residential Type Three (RR3) zone, except for one or more of the following uses:

- a. Vacation dwelling
- b. Single Detached Dwelling
- c. Park
- d. Home occupation

**4.2 RR3 ZONE REQUIREMENTS**

In a Rural Residential Type Three (RR3) zone, no person shall hereafter erect or use a building except in conformity with the following requirements:

	Communal or Municipal Water Supply Provided	Individual Water Supply & Sewage Disposal
a. Minimum lot area	1700 sq.m (18,298 sq.ft)	2000 sq.m (21,527 sq.ft)
b. Minimum lot frontage		
i. No shore lot line	25 sq.m (82 ft)	30 m (98 ft)
ii. With shore lot lines	30 m (98 ft)	30 m (98 ft)
c. Minimum front yard	7.5 m (25 ft)	7.5 m (25 ft)
d. Minimum rear yard	7.5 m (25 ft)	7.5 m (25 ft)
e. Minimum flankage yard	7.5 m (25 ft)	7.5 m (25 ft)
f. Minimum water setback	15 m (50 ft)	15 m (50 ft)
g. Maximum lot coverage	30 %	30 %
h. Maximum height	11 m (36 ft)	11 m (36 ft)
i. Minimum dwelling unit floor area	60 sq.m (645 sq.ft)	60 sq.m (645 sq.ft)
j. Minimum side yard: shall be 3 metres (9.8 ft) on one side, 1.2 metres (4 ft) on the other side plus 1 metre (3.3 ft) for each additional or partial storey above the first.		
k. Maximum number of dwelling units per lot		1

\* By-law Includes Major Update Amendment (By-Law 96-14)